

MERCEDES BENZ

SPRINTER

NORTH AMERICA: 2500/ 3000

EUROPE: 219 / 319 / 419 / 519

CODE / CODICE: 0500.7702

**COMPRESSOR / COMPRESSEUR /
KOMPRESSOR / COMPRESSORE / COMPRESOR :**

SELTEC: TM13 / 15 / 16

QUE: QP13 / 15 / 16

SANDEN SD7H15

FITTING INSTRUCTIONS

EINBAUANLEITUNGEN

INSTRUCTIONS POUR LE MONTAGE

ISTRUZIONI DI MONTAGGIO

INSTRUCCIONES DE MONTAJE

Contents

ENGLISH	4
Compressor Configurations	4
Kit Details	5
Vehicle Details	5
Forward	5
Parts View.....	6
Parts list.....	6
Standard Fastener Torque Values	6
Pre Installation.....	7
Installation	7
Compressor Installation.....	7
Auto tensioner	8
Belt Drive Installation	8
Finish	9

COMPATIBLE COMPRESSORS / RECOMENDADAS COMPRESORES

VALEO	TM-13 HS	TM-15 HS	TM-16 HS
Comp No	0381.0202	0381.0002	0381.0312
Valeo No.	435.54120	435.55120	435.56134
Mounting	Ear	Ear	Ear
Rotor	8PV	8PV	8PV
GL	46.55	46.55	46.55
Armature	3E	3E	3E
Diameter	123	123	123
Voltage	12	12	12
Orientation	V	V	V
Fitting	3/4 x 7/8	3/4 x 7/8	3/4 x 7/8
Manifold	Bolt	Bolt	Bolt

QUE	QP-13 HS	QP-15 HS	QP-16 HS
Comp No	0391.0202	0391.0002	0391.0312
Que No.	QP13.1302	QP15.1171	QP16.1195
Mounting	Ear	Ear	Ear
Rotor	8PV	8PV	8PV
GL	46.55	46.55	46.55
Armature	3E	3E	3E
Diameter	123	123	123
Voltage	12	12	12
Orientation	V	V	V
Fitting	3/4 x 7/8	3/4 x 7/8	3/4 x 7/8
Manifold	Bolt	Bolt	Bolt

SANDEN	-	-	SD7H15
Comp No	-	-	0370.0011
Sanden No	-	-	4864
Mounting	-	-	EAR
Rotor	-	-	8PV
GL	-	-	50.1
Armature	-	-	SL
Diameter	-	-	123
Voltage	-	-	12
Orientation	-	-	PAD
Fitting	-	-	-

NOTES

--

COMPRESSOR KIT CONFIGURATIONS

PART NUMBER	COMPRESSOR KIT PART NOS						DESCRIPTION	QTY.
	0513.7702	0515.7702	0516.7702	0593.7702	0595.7702	0596.7702		
0381.0202	●						TM13 Ear Mount 8PV 3E 123 12V V 3/4 x 7/8 Bolt	1
0381.0002		●					TM15 Ear Mount 8PV 3E 123 12V V 3/4 x 7/8 Bolt	1
0381.0312			●				TM16 Ear Mount 8PV 3E 123 12V V 3/4 x 7/8 Bolt	1
0391.0202				●			QP13 Ear Mount 8PV 3E 123 12V V 3/4 x 7/8 Bolt	1
0391.0002					●		QP15 Ear Mount 8PV 3E 123 12V V 3/4 x 7/8 Bolt	1
0391.0312						●	QP16 Ear Mount 8PV 3E 123 12V V 3/4 x 7/8 Bolt	1

● = Additional parts to standard kits.

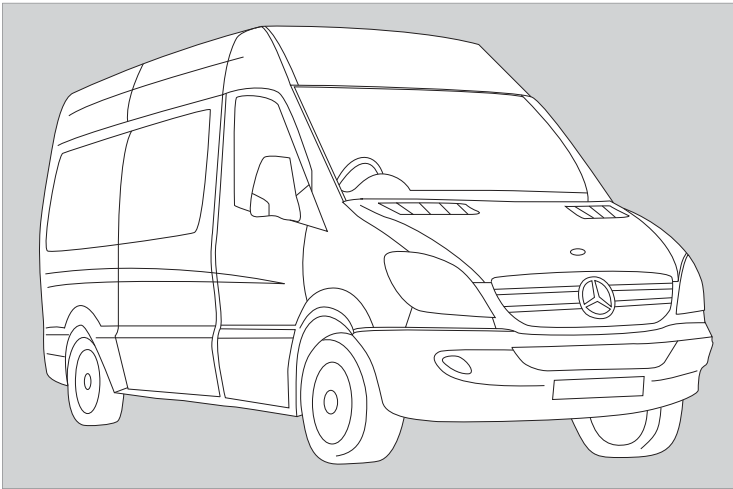

VEHICLE DETAILS

Manufacturer	Mercedes Benz
Make	Sprinter
Model	North America: 2500/ 3000 Europe: 219 / 319 / 419 / 519
Engine CC	OM642 Euro 5 / 6 / EEV
Engine Details	OM642 V6 CDI
Year	08.09>
Chassis Nos.	N/A
LHD	YES
RHD	YES
PAS	YES
A/C	YES / NO
Voltage	12v

KIT DETAILS

Kit Part No.	0500.7702
Description	Standard Kit
Compressor RPM	4695 @ Max Engine
	Power Output
Fitting Time	40 Minutes
Suction Fitting	90°
Discharge Fitting	90°
Belt Type	6PK 1400
Belt Part No	0820.1861
Note	+N63 / +LBS Option

FOREWORD

The purpose of this manual is to facilitate the installation of a direct drive compressor. The information given is merely instructive, should any complications arise contact the Technical department. The manufacturer's warranty does not cover any problems caused by defective installation or alterations made unless authorised. The manufacturer shall not be responsible for any injury, damage or loss caused directly or indirectly as a result of using this manual or the information contained within it.

Caution: Measures must be followed accurately to steer clear of the possibility of damage to individuals

Warning: This calls awareness to actions which must be pursued to avoid damage to the components.

NB: This calls awareness to make the job easier or gives useful information.

1 SAFETY MEASURES:

Before fitting the Compressor adapter drive kit, ensure the following for damage:

- a Inner and outer trim and body work
- b Engine idle pace
- c Check all the vehicle functions

Check list:

- a Ensure that the right kit has been selected
- b Before installing, check that all the correct pieces are present; also ensure that there are no missing or broken pieces
- c When fitting, make sure the vehicle is properly protected against damage.

Installation apparatus

- a Calibrated torque wrench
- b Hand service tools
- c Protective covers and shields

2 PRECAUTIONS

- a Detach the battery negative lead.
- b Torque all bolts where stated using a calibrated torque wrench.
- c Take extreme care with moving parts.
- d Remove the vehicle's ignition key and keep it with you.
- e Wear safeguards and make sure that liquid refrigerant never touches your skin

PARTS VIEW / VISTA EXPLOSIONADA

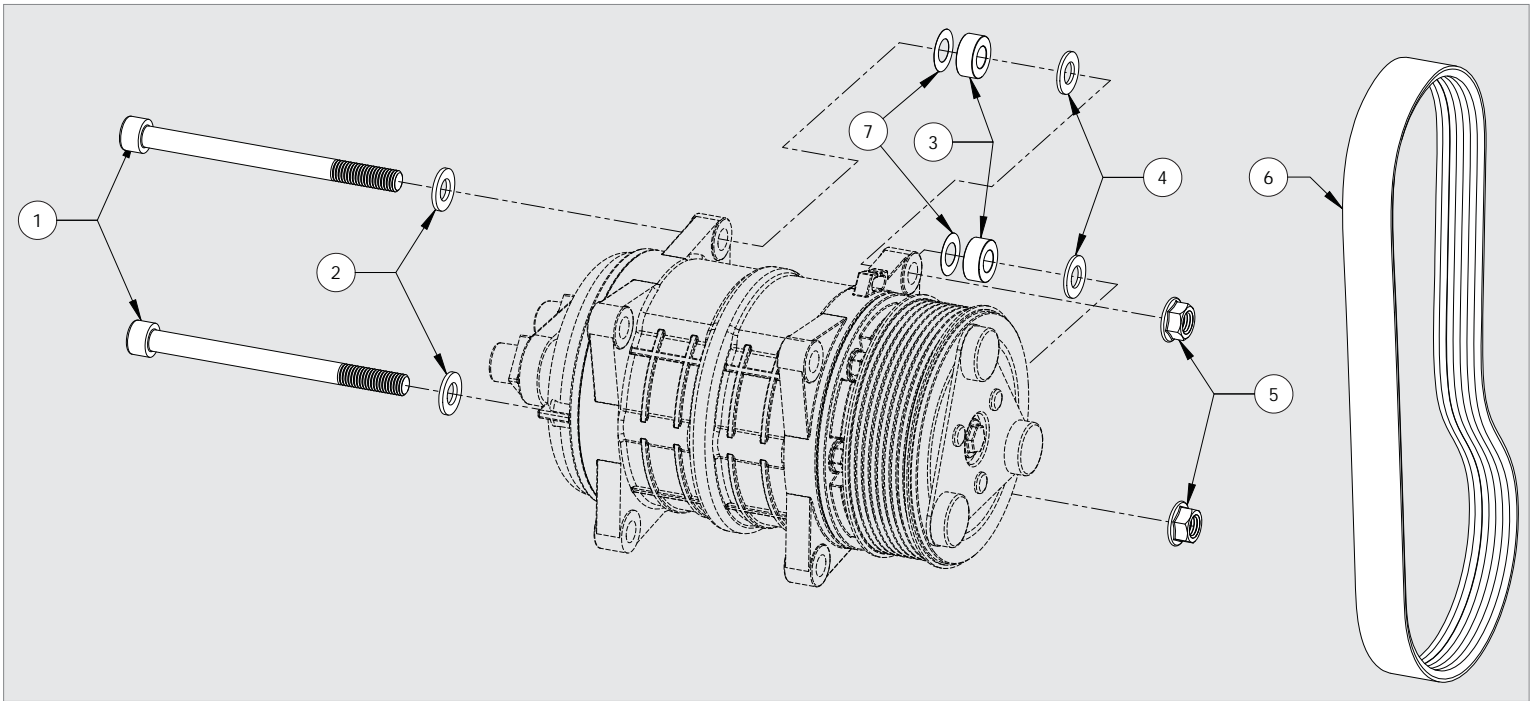

PARTS LIST / LISTA DE PIEZAS

ITEM	CODE / CODICE / KODE / CODIGO	DESCRIPTION / DESCRIZIONE / BESCHREIBUNG / DESCRIPCION	QTY.	COMMENTS
1	2705.0301	Hex socket head cap screw M10 x 130 :1.50 - 12.9	2	-
2	2809.0011	Washer M10 x 2 Flat DIN 125 - A 10.5	2	-
3	2803.6021	Spacer - 20.00 OD x 10.40 ID x 8.3	2	-
4	2803.9023	Spacer - 20.00 OD x 10.50 ID x 1.60	2	-
5	2735.0071	Durlok Hexagon Flange Nut - M10 : 1.50	2	-
6	0820.1861	Belt - Poly Groove 6PK 1400	1	-
7	2803.6011	Shim - 20.00 OD x 11.00 ID x 0.1 L	4	-

STANDARD FASTENER TORQUE VALUES

In the absence of specific torque values detailed in this fitting instruction manual, the following chart can be used as a guide to the maximum safe torque for specific size and grade of fastener.

VALORES ESTÁNDAR DE LOS PARES DE APRIETE Y FIJACIÓN

En ausencia de valores para los pares de apriete específicos detallados en este manual de instrucciones de montaje, se puede utilizar la siguiente tabla como guía para consultar el máximo par de torsión seguro para un tamaño concreto y su grado de fijación.

STRENGTH	4.8		8.8		10.9		12.9	
	Max Torque		Max Torque		Max Torque		Max Torque	
Dia / Pitch	lb.ft	Nm	lb.ft	Nm	lb.ft	Nm	lb.ft	Nm
M5 x 0.80	2	3	4.5	6	6.5	9	7.5	10
M6 x 1.00	4	5.5	7.5	10	11	15	13	18
M8 x 1.25	10	13	18	25	26	35	33	45
M10 x 1.25	20	27	39	53	57	78	66	90
M10 x 1.50	18	25	37	50	55	73	63	86
M12 x 1.75	33	45	63	85	97	130	111	150
M14 x 2.00	55	75	103	140	151	205	177	240
M16 x 2.00	85	115	159	215	232	315	273	370

PRE- INSTALLATION

Note: Before proceeding please read the installation precautions. The letters on drawings relate to text, numbers circled relate to the parts list in this manual.

INSTALLATION

Euro 5 / 6 vehicles only

1. Remove and retain bolt (A) securing the fan support tube - Fig 1
2. Disconnect the wiring plug (B) from the fan assembly - Fig 1
3. Remove and discard the original stretch belt (C) - Fig 1

Note: It is not necessary to remove the viscous fan to install this mount kit.

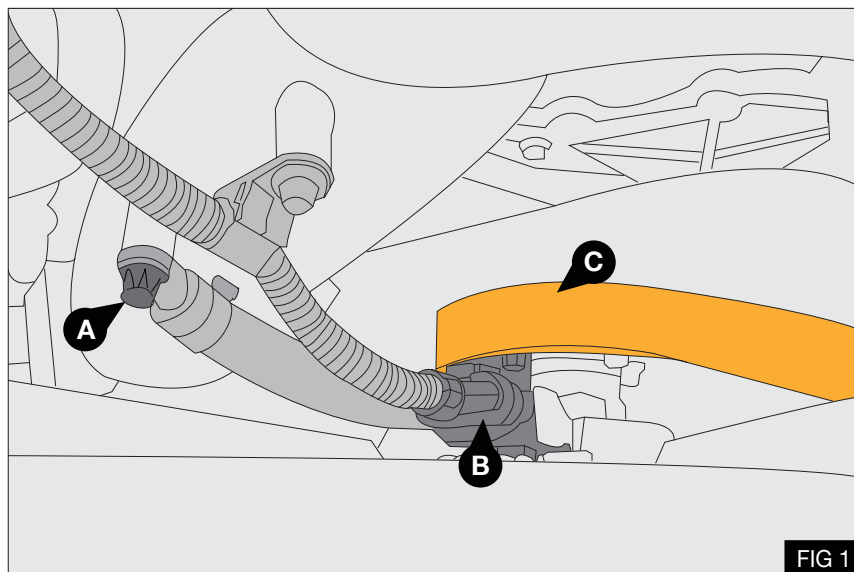

COMPRESSOR INSTALLATION

1. Install the compressor to the mount bracket (D) using M10 x 130 bolts (1) fitted with 2mm thick washers (2). Place the 8.3mm spacers (3) between the rear compressor ears and the bracket, Insert the 1.6mm spacers (4) between the front compressor ears and the mount bracket (See note below) - Fig 2

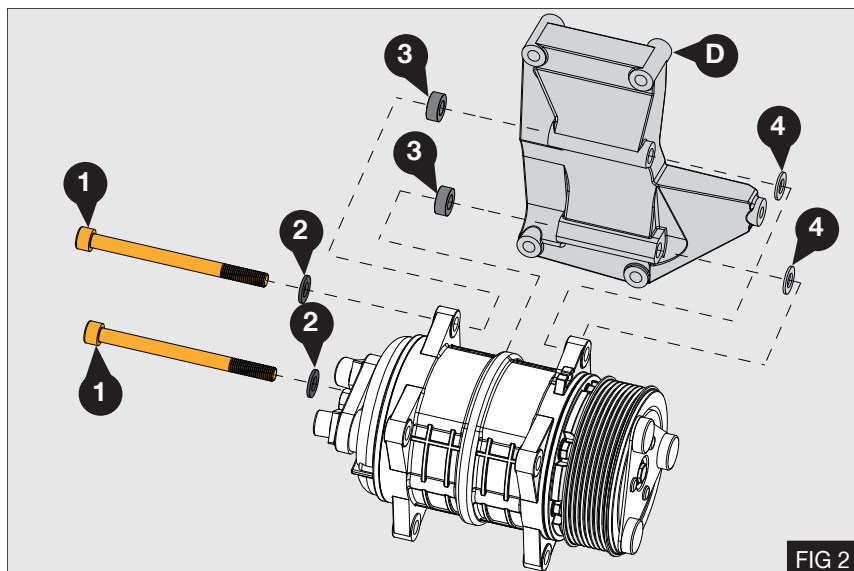

2. Check the gap between the compressor ears and fit the supplied shims (7) if required - Figs 3 & 4

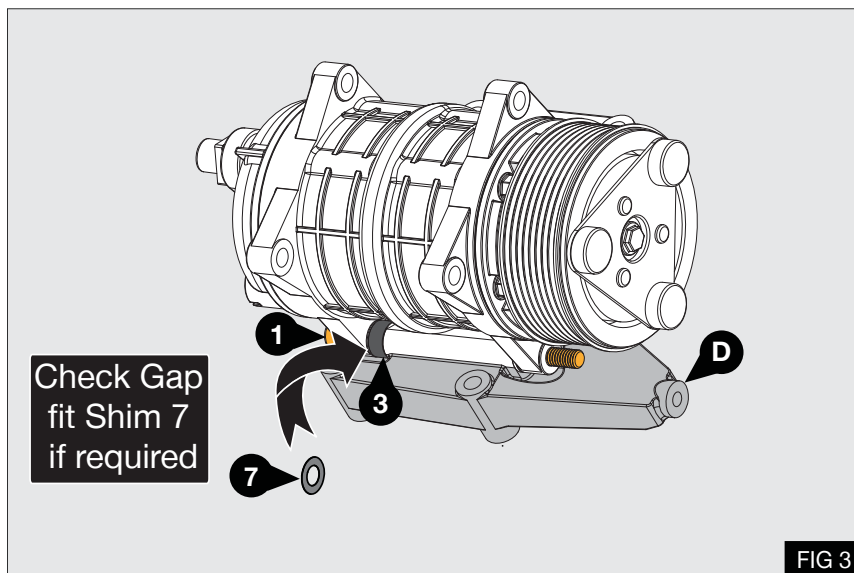

3. Fit nut (5) to the compressor securing bolts (1) - Fig 4

- Torque the 2 x bolts (1) to 63 Nm / 46 lb ft using a calibrated torque wrench.

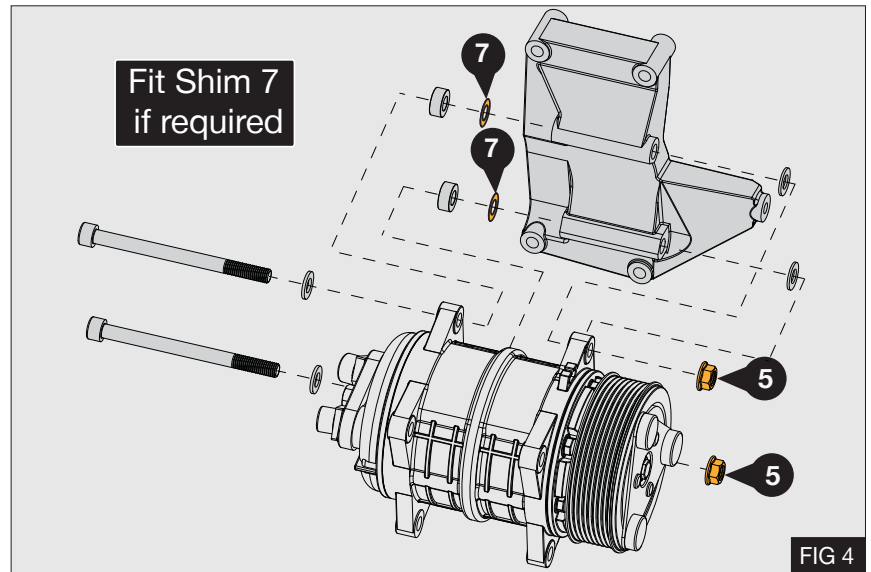

AUTO TENSIONER

1. Before installing the drive belt (6) cycle the tensioner assembly (E) through its full travel a minimum of three times - Fig 5

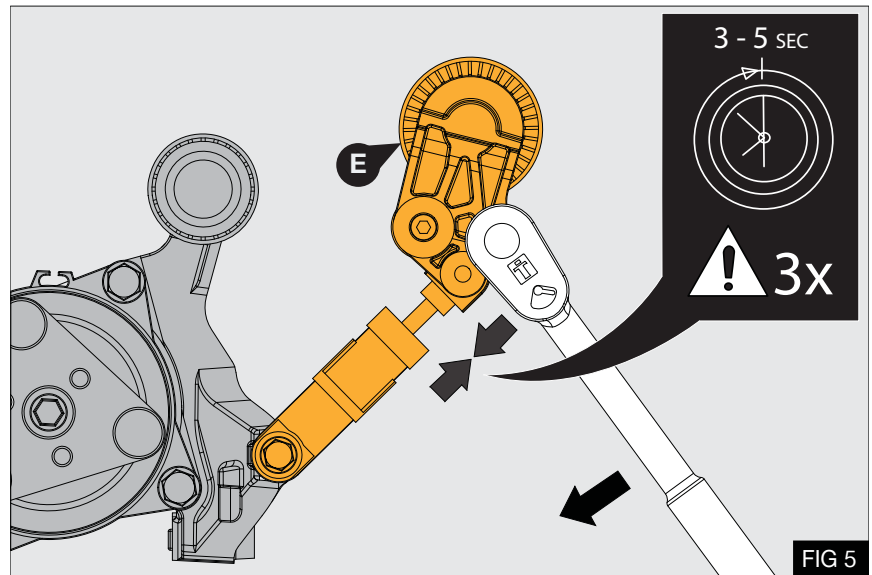

BELT DRIVE INSTALLATION

1. Feed the supplied belt (6) over the viscous fan and install as shown opposite - Fig 6

- A Crankshaft Pulley
- B Tensioner Pulley
- C Compressor
- D Idle Pulley
- E Fan Pulley

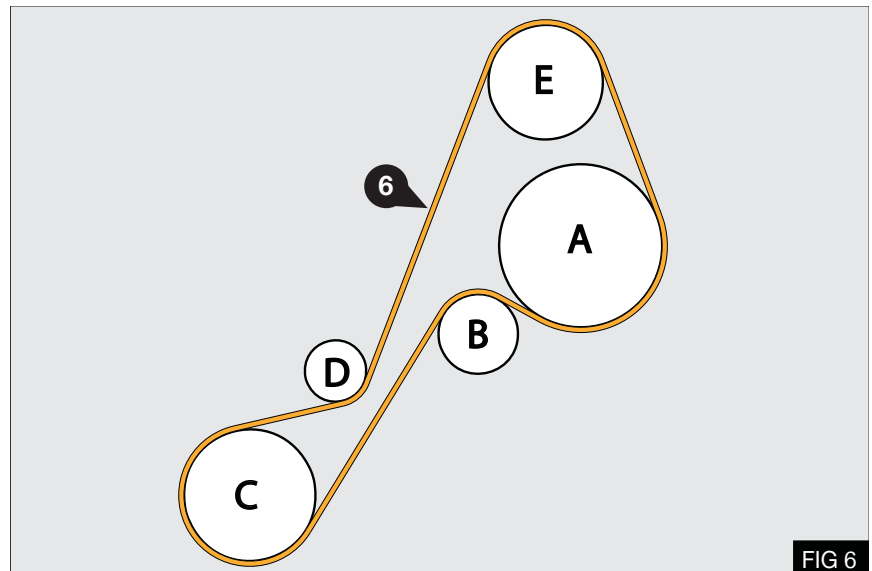

2. Place the belt in the correct groove of the compressor:

- A. Valeo / QUE / Sanden⁽¹⁾ compressors – Belt is installed with 1 spare groove at the front of the compressor pulley - Fig 7

⁽¹⁾Model Specific

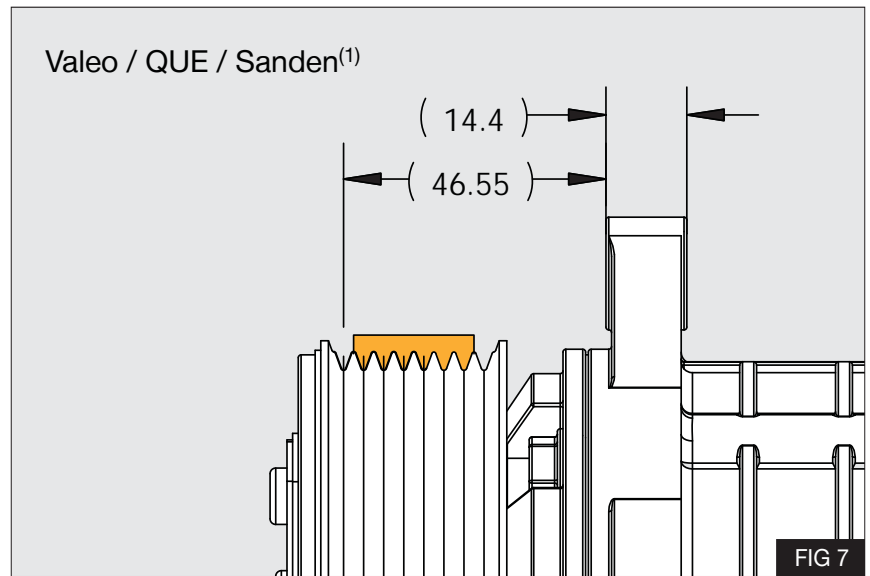

- B. Delphi / Sanden⁽¹⁾ compressors - Belt is installed with 2 spare grooves at the front of the compressor pulley - Fig 8

⁽¹⁾Model Specific

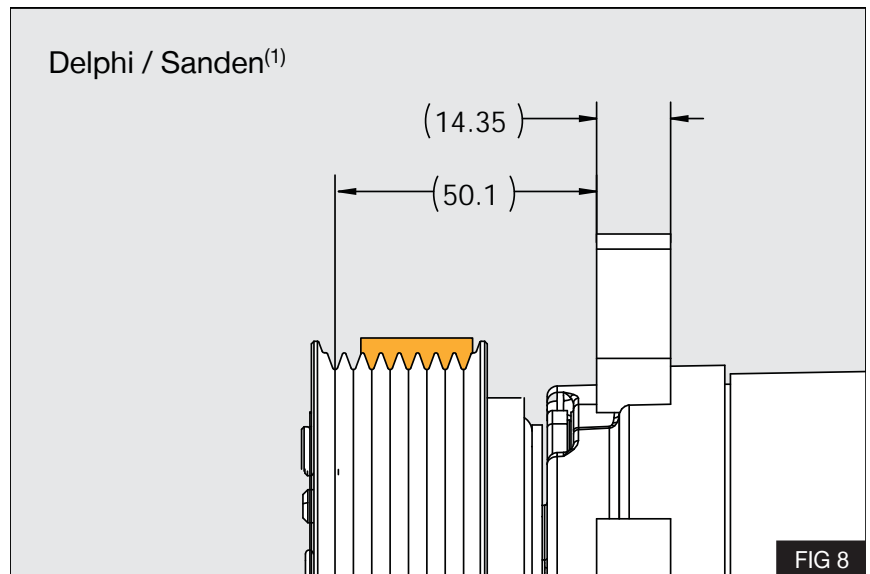

FINISH

1. Refit bolt ① securing the fan support tube - Fig 1
2. Reconnect the wiring plug ② to the fan assembly - Fig 1
3. Run the engine with the compressor clutch engaged for five minutes, Check all components.
4. Install the supplied belt label in the engine bay.

(EN)

Techni focuses on constant upgrading of its products. The Manufacturer reserves the right to modify the models and components described in the present publication at any time for technical or commercial reasons and without prior notice. For further information, contact Techni technical services.

(ES)

Techni aspira a un constante mejoramiento de su producción. La Fábrica se reserva el derecho de aportar en cualquier momento y sin preaviso modificaciones a los modelos y los componentes descritos en esta publicación por razones técnicas o comerciales. Para ulteriores informaciones dirigirse al servicio asistencia Techni.

SALES AND SERVICE
VENTAS Y SERVICIO

Techni
ENGINEERING SOLUTIONS

Techni US LLC
6546 Corporate Drive
Indianapolis
Indiana
46278

Telephone +1 (470) 685 5841
Email: info@techni.us